

Instructions for use

KitchenAid

Important safety instructions	4
Safeguarding the environment	6
Before using the appliance	6
Precautions and general recommendations	7
Energy-saving tips	7
Electrical connection for Great Britain and Ireland only	8
First use	9
Appliance maintenance and cleaning	9
Changing the bulb or led (depending on the model)	9
When the appliance is not in use	10
During blackouts	10
Refrigerator compartment	10
Freezer compartment	11
Defrosting the freezer compartment (depending on the model)	11
“Zero degrees” box (depending on the model)	12
Use of wooden accessories (if present)	14
After-Sales Service	15

Important safety instructions

- **WARNING:** to avoid a hazard due to instability, positioning or fixing of the appliance must be done in accordance with the manufacturer instructions.
 - **WARNING:** keep the appliance ventilation openings clear of obstruction.
 - **WARNING:** do not damage the appliance refrigerant circuit pipes.
 - **WARNING:** Do not use mechanical, electric or chemical means other than those recommended by the Manufacturer to speed up the defrost process.
 - **WARNING:** Do not use or place electrical devices inside the appliance compartments if they are not of the type expressly authorised by the Manufacturer.
 - **WARNING:** (if present) ice-makers and/or water dispensers not directly connected to the water supply must be filled with potable water only.
 - **WARNING:** (if present) automatic ice-makers and/or water dispensers must be connected to a water supply that delivers potable water only, with main water pressure between 0,17 and 0,81 MPa (1,7 and 8,1 bar).
- Information:** This appliance does not contain CFCs.
- Appliances with Isobutane (R600a): isobutane is a natural gas without environmental impact, but is flammable. Therefore, make sure the refrigerant circuit pipes are not damaged. Keep special attention in case of damaged pipes emptying the refrigerant circuit.
 - C-Pentane is used as blowing agent in the insulation foam and it is a flammable gas. Pay special attention during disposal operations.
 - This appliance is intended to be used in household and similar applications such as - staff kitchen areas in shops, offices and other working environments;
- farm houses and by clients in hotels, motels and other residential type environments;
- bed and breakfast type environments;
- catering and similar non-retail applications
 - Do not store explosive substances such as aerosol cans with a flammable propellant in this appliance.
 - This appliance can be used by children aged from 8 years and above and persons with reduced physical, sensory or mental capabilities or lack of experience and knowledge if they have been given supervision or instruction concerning use of the appliance in a safe way and understand the hazards involved.

- Cleaning and user maintenance shall not be made by children without supervision.
- To avoid the risk of children becoming trapped and suffocating, do not allow them to play or hide inside the appliance.
- It must be possible to disconnect the appliance from the power supply by unplugging it if plug is accessible, or by means of an accessible multi-pole switch installed upstream of the socket in conformity with national safety standards.
- Plug the appliance into a grounding socket: the appliance must be correctly connected to an approved earthing system.
- Do not use single/multi adapters or extension cords.
- During installation, make sure the appliance does not damage the power cable.
- Do not pull the appliance power cable
- The appliance must be handled and installed by two or more persons.
- Installation and maintenance including replacement of the supply cord must be carried out by the manufacturer or a qualified technician, in compliance with the manufacturer's instructions and the local safety regulations in force. In order to avoid a hazard do not repair or replace any part of the appliance including the supply cord, unless specifically stated in the user manual.
- This appliance can be used by children aged from 8 years and above and persons with reduced physical, sensory or mental capabilities or lack of experience and knowledge if they have been given supervision or instruction concerning use of the appliance in a safe way and understand the hazards involved.
- Cleaning and user maintenance shall not be made by children without supervision.
- To avoid the risk of children becoming trapped and suffocating, do not allow them to play or hide inside the appliance.
- It must be possible to disconnect the appliance from the power supply by unplugging it if plug is accessible, or by means of an accessible multi-pole switch installed upstream of the socket in conformity with national safety standards.
- Plug the appliance into a grounding socket: the appliance must be correctly connected to an approved earthing system.
- Do not use single/multi adapters or extension cords.
- During installation, make sure the appliance does not damage the

power cable.

- Do not pull the appliance power cable
- The appliance must be handled and installed by two or more persons.
- Installation and maintenance including replacement of the supply cord must be carried out

by the manufacturer or a qualified technician, in compliance with the manufacturer's instructions and the local safety regulations in force. In order to avoid a hazard do not repair or replace any part of the appliance including the supply cord, unless specifically stated in the user manual.

Safeguarding the environment

1. Packing

The packing material is 100% recyclable and bears the recycling symbol . For disposal, comply with the local regulations. Keep the packing materials (plastic bags, polystyrene parts, etc.) out of the reach of children, as they are a potential source of danger.

2. Scrapping/Disposal

The appliance is manufactured using recyclable material.

This appliance is marked in compliance with European Directive 2002/96/EC on Waste Electrical and Electronic Equipment (WEEE). By ensuring the correct disposal of this appliance, you can help prevent potentially negative consequences for the environment and the health of persons.

The symbol  on the appliance, or on the accompanying documents, indicates that this appliance should not be treated as domestic waste but must be taken to a special collection centre for the recycling of electrical and electronic equipment. When scrapping the appliance, make it unusable by cutting off the power cable and removing the doors

and shelves so that children cannot easily climb inside and become trapped.

Scrap the appliance in compliance with local regulations on waste disposal, taking it to a special collection centre; do not leave the appliance unattended even for a few days, since it is a potential source of danger for children.

For further information on the treatment, recovery and recycling of this product, contact your competent local office, the household waste collection service or the shop where you purchased the appliance.

Declaration of conformity

- This appliance has been designed for preserving food and is manufactured in compliance with Regulation (CE) No. 1935/2004.
- This appliance has been designed, manufactured and marketed in compliance with:
 - safety objectives of the "Low Voltage" Directive 2006/95/CE (which replaces 73/23/CEE and subsequent amendments);
 - the protection

Before using the appliance

To ensure best use of your appliance, carefully read the operating instructions which contain a description of the product and useful advice. Keep these instructions for future reference.

1. After unpacking the appliance, make sure it is not damaged and that the door closes properly.

Any damage must be reported to the dealer within 24 hours of delivery of the appliance.

2. Wait at least two hours before switching the appliance on, to ensure that the refrigerant circuit is fully efficient.
3. Clean the inside of the appliance before using it.

Precautions and general recommendations

INSTALLATION

- Be careful not to damage the floors (e.g. parquet) when moving the appliance.
- Make sure the appliance is not near a heat source.
- Install and level the appliance on a floor strong enough to take its weight and in a place suitable for its size and use.
- The appliance is arranged for operation in places where the temperature comes within the following ranges, according to the climatic class given on the rating plate. The appliance may not work properly if it is left for a long time at a temperature outside the specified range.

Climatic Class	Amb. T. (°C)
SN	From 10 to 32
N	From 16 to 32
ST	From 16 to 38
T	From 16 to 43

- Make sure the voltage specified on the rating plate corresponds to that of your home.

SAFE USE

- Do not store or use petrol, flammable liquids or gas in the vicinity of this or other electrical appliances. The fumes can cause fires or explosions.
- Do not swallow the contents (non-toxic) of the

Energy-saving tips

- Install the appliance in a dry, well ventilated room far away from any heat source (e.g. radiator, cooker, etc.) and in a place not exposed directly to the sun. If required, use an insulating plate.
- To guarantee adequate ventilation follow installation instructions.
- Insufficient ventilation on back of the product increases energy consumption and decreases cooling efficiency.
- The internal temperatures of the appliance may be affected by the ambient temperature, frequency of door opening, as well as location of the appliance. Temperature setting should take into consideration these factors.
- Allow warm food and drinks to cool down before placing in the appliance.
- Do not obstruct the fan (if available) with food items.
- After placing the food check if the door of compartments closes properly, especially the freezer door.
- Reduce to a minimum door opening.
- When thawing frozen food, place them in the refrigerator. The low temperature of the frozen

ice packs (in some models).

- Do not eat ice cubes or ice lollies immediately after taking them out of the freezer since they may cause cold burns.
- For products designed to use an air filter inside an accessible fan cover, the filter shall be always in position when the refrigerator is in function.
- Before carrying out any maintenance or cleaning operation, unplug the appliance or disconnect it from the power supply.
- Use the refrigerator compartment only for storing fresh food and the freezer compartment only for storing frozen food, freezing fresh food and making ice cubes.
- Do not store glass containers with liquids in the freezer compartment since they may break.
- Avoid storing unwrapped food in direct contact with internal surfaces of the refrigerator or freezer compartments.
- “The bulb used inside the appliance is specifically designed for domestic appliances and is not suitable for general room lighting within the home (EC Regulation 244/2009)”.

The Manufacturer declines any liability for injury to persons or animals or damage to property if the above advice and precautions are not respected.

products cools the food in the refrigerator.

- Appliances could have special compartments (Fresh Food Compartment, Zero Degree Box,...). In case not differently specified in the specific booklet of product, they can be removed, maintaining equivalent performances.
- Positioning of the shelves in the refrigerator has no impact on the efficient usage of energy. Food should be placed on the shelves in such way to ensure proper air circulation (food should not touch each other and distance between food and rear wall should be kept).
- You can increase storage capacity of frozen food by removing baskets and, if present, Stop Frost shelf, maintaining an equivalent energy consumption.
- Damaged gasket must be replaced as soon as possible.
- High energy class products are fitted with highefficiency motors that remain operational for longer, but have a low power consumption. Do not worry if the engine continues to run for longer periods.

Electrical connection for Great Britain and Ireland only

Warning - this appliance must be earthed

Fuse replacement

If the mains lead of this appliance is fitted with a BS 1363A 13amp fused plug, to change a fuse in this type of plug use an A.S.T.A. approved fuse to BS 1362 type and proceed as follows:

1. Remove the fuse cover (A) and fuse (B).
2. Fit replacement 13A fuse into fuse cover.
3. Refit both into plug.

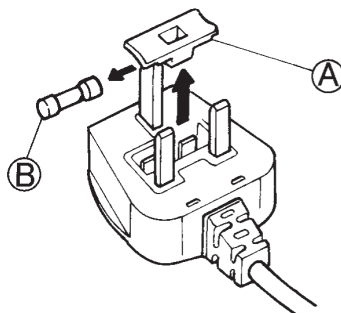

Important:

The fuse cover must be refitted when changing a fuse and if the fuse cover is lost the plug must not be used until a correct replacement is fitted.

Correct replacement are identified by the colour insert or the colour embossed in words on the base of the plug.

Replacement fuse covers are available from your local electrical store.

For the Republic of Ireland only

The information given in respect of Great Britain will frequently apply, but a third type of plug and socket is also used, the 2-pin, side earth type.

Socket outlet / plug (valid for both countries)

If the fitted plug is not suitable for your socket outlet, please contact After-sales Service for further instruction. Please do not attempt to change plug yourself. This procedure needs to be carried out by a qualified technician in compliance with the manufactures instructions and current standard safety regulations.

First use

Connect the appliance to the mains power supply.

A beep may be emitted by some models, to indicate that the temperature alarm has intervened: press and hold the button to switch off acoustic alarms. As applicable, insert the anti-bacterial/anti-odour filter into the fan as indicated on the filter package.

Note: after switching on, the refrigerator needs approximately 4/5 hours to reach the correct temperature for storing a normal fridge load of food.

Appliance maintenance and cleaning

Clean the appliance regularly using a cloth and a solution of lukewarm water and neutral detergent specifically formulated for refrigerator interiors. Never use abrasive detergents. Clean inside the defrost water drain outlet on the rear wall of the refrigerator (near the fruit and vegetable crisper drawer) regularly, using the tool supplied with the appliance so as to ensure defrost water is removed correctly (see figure).

Before all cleaning or maintenance procedures, unplug the appliance from the mains or disconnect the electricity supply.

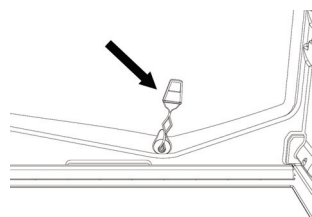

Changing the bulb or led (depending on the model)

Always unplug the refrigerator before replacing any light bulbs, then follow the relevant instructions in accordance with the type of lighting fitted in your appliance.

Only use bulbs of the same type, which can be requested from the After-Sales Service and authorised dealers.

Lighting type 1)

1. Loosen the screws and take off the lamp cover.
2. The lamp has a bayonet bulb and needs to be pulled out, not unscrewed, following the directions of the arrows as indicated.
3. After the new bulb has been inserted, replace the lamp cover and wait five minutes before plugging the appliance back in.

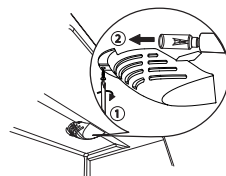

Lighting type 2)

To remove the light bulb, turn anticlockwise as shown in the figure. Wait for 5 minutes before reconnecting the appliance.



Lighting type 3)

If the product has LED lighting which is in need of replacing, contact the After-Sales Service for assistance.

LED lights last longer than normal bulbs, they illuminate better and are more environmentally friendly

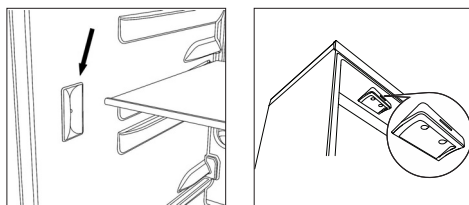

When the appliance is not in use

Unplug the appliance from the mains, then empty, defrost (if necessary) and clean it. Leave the doors ajar, so that air can circulate inside the compartments. This will prevent the formation of mould and bad odours.

During blackouts

Keep the doors closed to allow the stored food to stay cold as long as possible. Do not refreeze partially thawed food. If the blackout persists, the blackout alarm may sound (depending on the model).

Refrigerator compartment

The refrigerator compartment is designed for the storage of fresh food and beverages.

Refrigerator compartment defrosting is completely automatic.

Droplets of water on the rear wall of the compartment indicate that the periodic automatic defrost cycle is in progress. The defrost water is automatically routed to a drain outlet and into a container from which it evaporates.

Depending on the model, the appliance may have a special box ("Meat & Fish" or "Zero Degrees") which is ideal for the storage of fresh meat and fish.

Important: refrigerator accessories must not be washed in a dishwasher.

Note: the ambient temperature, the door opening frequency and the position of the appliance may affect temperatures inside the two compartments. Set the temperature in accordance with these factors.

Note: when there is a lot of moisture inside the refrigerator compartment and on the glass shelves in particular, condensation may form. In this case, we recommend closing any liquid-filled containers (e.g.: saucepans full of stock), wrapping foods with a high liquid content (e.g.: vegetables) and setting the temperature to a warmer value.

Removing the crisper drawer (depending on the model)

If your product only has a crisper drawer, to facilitate its removal we recommend emptying (and, if necessary, removing) the two lower door trays beforehand.

Fan and anti-bacterial/anti-odour filter (depending on the model)

The fan will ensure uniform air circulation inside the compartment, for improved food storage and excess moisture reduction. Do not obstruct the fan inlet. The fan can be activated/deactivated manually (see Quick Start Guide); when activated, it works automatically as necessary.

Freezer compartment

The freezer compartment  stores frozen food (for the period indicated on the package) and freezes fresh food. The amount of fresh food that can be frozen in 24 hours is shown on the rating plate; place the food in the freezer compartment (see Quick Start Guide), leaving leaving enough space around the packages to allow air to circulate. Refreezing partially thawed food is not recommended. It is important to wrap food so that no water, moisture, or vapour may penetrate.

To save energy and prolong the life of the appliance, make sure hot foods are never placed inside it.

Note: the ambient temperature, door opening frequency and position of the appliance can affect the temperatures inside the two compartments. Set the temperature based on these factors.

Making ice cubes

Fill the ice cube tray (where provided) 2/3 full and place it in the freezer compartment. Never use sharp or pointed objects to remove the ice.

Removing drawers (depending on model)

Pull the drawers all the way out, lift them up a little and remove. To create more space, the freezer compartment can also be used as follows:

A) If the freezer compartment base resembles figure **A**, remove the upper drawers and/or lids. The lower drawer should be left in position. Make sure that, once the food has been placed on the racks/shelves, the door closes properly.

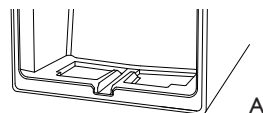

B) If the freezer compartment base resembles figure **B**, remove all drawers or lids. Make sure that, once the food has been placed on the racks/shelves, the door closes properly.

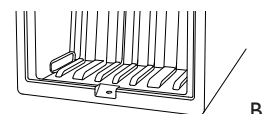

Removing the lid (if present)

Open the lid and remove the pin, as illustrated in figure C.

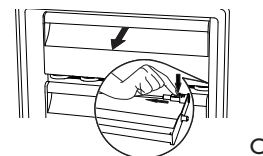

Defrosting the freezer compartment (depending on the model)

No Frost models do not need defrosting.

For other models, if frost forms in the freezer compartment, we recommend it is defrosted twice a year or whenever an excessive amount of frost has formed (3 mm thickness).

It is perfectly normal for frost to form.

The amount of frost which forms and the rate at which it builds up depends on room temperature and humidity, and on how often the door is opened. To defrost, unplug the appliance and remove all foodstuffs. Leave the door ajar to allow the frost to melt. For products with a freezer compartment below the refrigerator compartment, the defrost water drain pipe can be removed (see figure) and a recipient placed underneath. After defrosting, replace the drain pipe, making sure that no water is left in it. Clean inside the freezer compartment and dry carefully. Switch the appliance back on and place the food back inside.

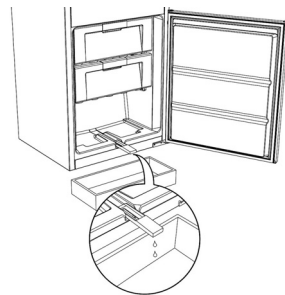

“Zero degrees” box (depending on the model)

The “Zero Degrees” box is specifically designed to maintain a low temperature and a suitable humidity level, in order to keep foods fresher for longer (e.g. meat, fish, fruit and winter vegetables).

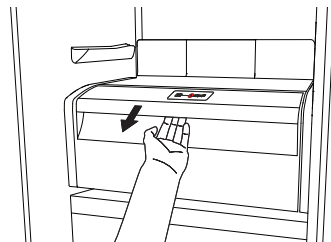

Activating and deactivating the box

The temperature inside the box, when active, is approximately 0°.

To activate the compartment, press the button shown in the figure for more than 1 second, until the symbol lights up

The symbol lit indicates that the compartment is functioning. Press the button again for more than 1 second to deactivate the compartment

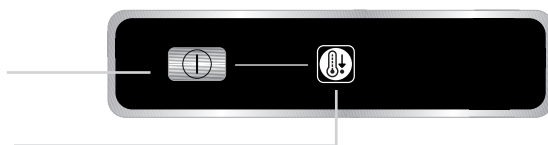

The following factors are vital for the “Zero Degrees” box to work properly:

- the refrigerator compartment must be switched on
- the temperature of the refrigerator compartment must be between +2°C and +6°C
- the box must be inserted to enable activation
- no special functions must have been selected (Standby, Cooling-Off, Vacation – where applicable).

If one of these special functions has been selected, the “Zero Degrees” box must be deactivated manually, and any fresh food inside it removed. If manual deactivation does not take place, the box will be deactivated automatically after 8 hours.

Note:

- if the symbol does not light up when the box is activated, check that the box is properly inserted; if the problem persists, contact your nearest authorized After-sales Service
- if the box is active and the drawer open, the symbol on the control panel may be deactivated automatically. If the drawer is inserted, the symbol will become active again
- irrespective of the state of the box, a slight noise may be heard: this is normal and is not a cause for concern.
- when the box is not active, the temperature inside it depends on the general temperature inside the refrigerator compartment. In this case, we recommend it is used to store fruit and vegetables which are not sensitive to cold temperatures (fruits of the forest, apples, apricots, carrots, spinach, lettuce, etc.).

Important: If the function is activated and food with high water content is present, condensate may form on the shelves. In this case, temporarily deactivate the function.

When placing small containers and food products on the top shelf of the “zero degrees” compartment, make sure they do not accidentally fall between the drawer and the back of the refrigerator compartment

Removing the "Zero Degrees" box:

The "**Zero Degrees**" box can be removed to create more space inside the refrigerator. In this case proceed as follows:

- to facilitate removal, we recommend emptying (and if necessary, removing) the two lower door trays
- switch off the box
- pull out the drawer and the white plastic shelf underneath the box.

Note: the upper shelf and the side supports cannot be removed.

To restore "**Zero Degrees**" box operation, make sure you replace the white plastic shelf underneath the box before inserting the drawer and reactivating the function. To optimise energy consumption, we recommend you deactivate the "**Zero Degrees**" box and remove it.

Clean the box and all its parts regularly, using a cloth and a solution of warm water and neutral detergent specifically formulated for refrigerator interiors (take care not to immerse the white plastic shelf underneath the box in water).

Before cleaning the box (including the outside), remove the drawer so as to disconnect the box from the electricity supply.

Never use abrasive detergents.

Use of wooden accessories (if present)

Haute cuisine*

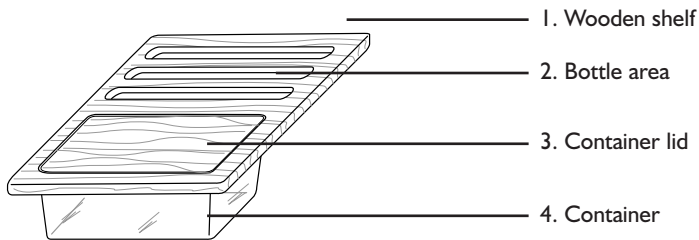

*with selected models only

Haute cuisine can be used in 2 different positions

With the container below

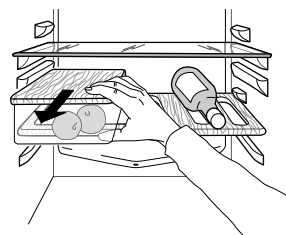
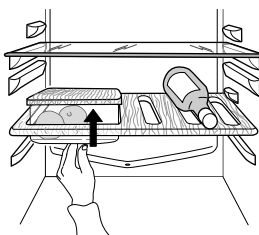
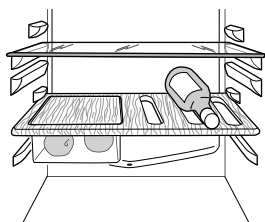
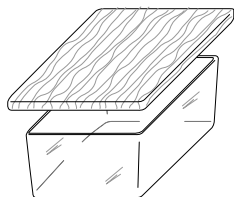

With the container on top, using the lid as a base

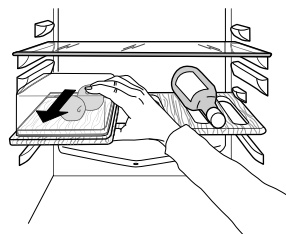
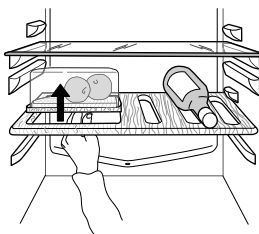
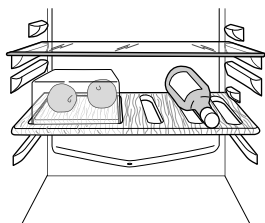
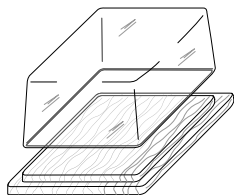

Cheese box*

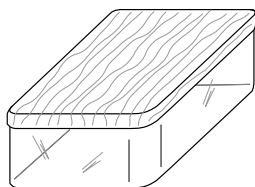

Both Haute cuisine and Cheese box can be used for serving food at the table. Do not use them in the freezer, microwave oven or on other heat sources.

Do not chop food directly on the wooden surface as it may become scored.

Tips for cleaning:

Do not wash the wooden or plastic components in the dishwasher; we recommend washing them by hand with mild detergent, without the use of abrasive sponges.

After-Sales Service

Before contacting the After-Sales Service:

Switch the appliance on again to see if the problem has been solved. If it has not, unplug the appliance and wait for about an hour before switching on again.

If the appliance is still not working after you have gone through all the checks listed in the troubleshooting guide and switched it off then on again, contact the After-Sales Service to explain the problem and have the following information ready:

- the type of fault
- the model
- the type and serial number of the appliance (given on the rating plate)
- the Service number (the number after the word SERVICE on the rating plate inside the appliance)

SERVICE 0000 000 00000



Note:

the door opening direction can be changed. If this operation is performed by the After-Sales Service it is not covered by the warranty.



FOR THE WAY IT'S MADE.

Printed in Italy
/// 03/15

400010780185

