

**Refrigerator Compartment**

- A. Fan and antibacterial and anti-odour filter (depending on the model)
- B. Control panel with LED lights
- C. Shelves
- D. Level covering fruit and vegetable drawer
- E. Fruit and vegetable drawer
- F. Rating plate (located at side of crisper)
- M. Door trays
- N. Bottle holder (if provided)
- O. Bottle shelf

**Freezer Compartment**

- G. Top drawer or door (frozen and deep-frozen food storage zone)
- H. Middle drawer (area for storing frozen and deep frozen food)
- I. Lower drawer (freezing area)
- L. Ice cube trays (if provided)

**Note:** All of the drawers, door shelves and shelves can be removed.

The ideal food storage temperatures are already factory-set

**Read the instructions carefully before using the appliance. Features, technical data and images may vary according to the model.**

- Least cold zone
- Medium zone
- Coldest zone
- Fruit & vegetable zone

**LED Light**

LEDs last longer than traditional light bulbs, improve internal visibility and are environmentally friendly. Contact the Service Centre if replacement is necessary.

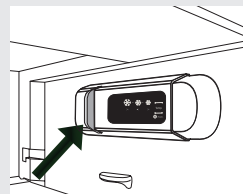

**Freezing fresh food**

Arrange the fresh food to be frozen in the freezing area in the freezer compartment avoiding the food coming into direct contact with food that is already frozen. To maximise the freezing speed, the lower drawer can be removed and the food can be placed directly on the bottom of the compartment. The freezing will be complete after 24 hours.

**Fan (if available)**

You can turn the fan on/off by pressing the button on the base (as shown in the figure). If the ambient temperature exceeds 27°C, or if drops of water are present on the glass shelves, it is essential that the fan is on to ensure the proper preservation of the food. Deactivation of the fan allows energy consumption to be optimised.

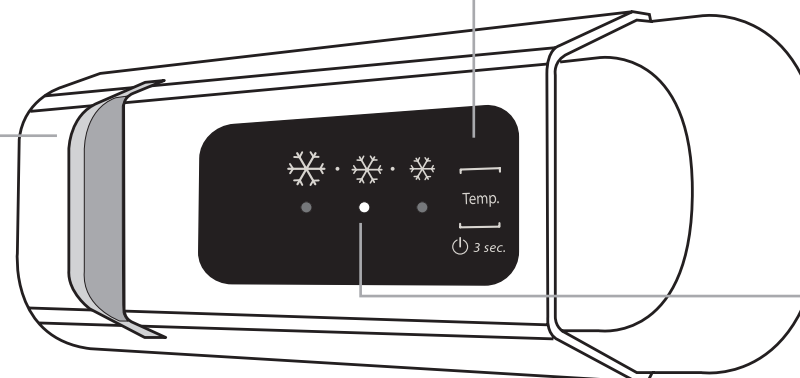
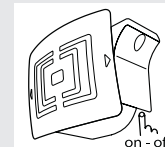

**On/Stand-by**

Press the "Temp." button for 3 seconds to turn off the appliance (the control panel and light will stay turned off). Press the button again briefly to reactivate the appliance.

**Note:** This does not disconnect the appliance from the power supply

**Refrigerator compartment temperature**

The three LED indicators indicate the refrigerator compartment set temperature. A different temperature can be set using the "Temp." button.

The following adjustments are possible:

LEDs lit	Set temperature
	High (less cold)
	Medium-high
	Medium
	Medium-low
	Low (colder)

What to do if...	Possible reasons:	Solutions:
	There may be an appliance power supply problem.	Check that: <ul style="list-style-type: none"> <li>- there is not a power outage</li> <li>- the plug is properly inserted in the power socket and the mains double-pole switch (if present) is in the correct position (i.e. allows the appliance to be powered)</li> <li>- the household electrical system protection devices are efficient</li> <li>- the power cable is not broken.</li> </ul>
The control panel is switched off, the appliance does not work.	The appliance could be in On/stand by mode.	Turn the appliance on by briefly pressing the "Temp" button (see On/Stand-by function).
The inside light does not work.	The light may need replacing. Malfunction of a technical component.	Contact an authorized Service Centre.
The inside light flashes.	Door alarm active. It is activated when the refrigerator compartment door remains open for a prolonged period of time.	To stop the alarm, close the refrigerator door. On reopening the door, check the light works.
The temperature inside the compartments is not low enough.	There could be various causes (see "Solutions")	Check that: <ul style="list-style-type: none"> <li>- the doors close properly</li> <li>- the appliance is not installed near a heat source</li> <li>- the set temperature is adequate</li> <li>- the circulation of air through the vents at the bottom of the appliance is not obstructed (see installation manual)</li> </ul>
There is water on the bottom of the refrigerator compartment.	The defrost water drain is blocked.	Clean the defrost water drain hole (see chapter "Appliance Maintenance and Cleaning").
There is too much frost in the freezer compartment.	The door of the freezer compartment does not close properly.	<ul style="list-style-type: none"> <li>- Check that there is nothing preventing the door from closing properly</li> <li>- Defrost the freezer compartment</li> <li>- Make sure the appliance has been correctly installed.</li> </ul>
The front edge of the appliance, at the door striker seal, is hot.	This is not a defect. It prevents condensation from forming.	No solution is necessary.
One or more green lights flash continuously.	Malfunction alarm The alarm indicates a fault in a technical component.	Contact an authorized Service Centre.
The temperature of the refrigerator compartment is too cold.	<ul style="list-style-type: none"> <li>- The set temperature is too cold.</li> <li>- A large amount of fresh food may have been placed in the freezer compartment.</li> </ul>	<ul style="list-style-type: none"> <li>- Try to set a less cold temperature.</li> <li>- If fresh food has been placed in the freezer compartment, wait until it has fully frozen.</li> </ul>

**Note:** some noises, such as gurgles and hissing, caused by the refrigeration system, are normal.