

Quick Reference Guide



“ This story begins with a cool glimpse of light which easily burns into a creative mind. A story of timeless moments of a serious passion prepared to become a delicious art creation. ”

Thanks for choosing

KitchenAid
FOR THE WAY IT'S MADE.

Built-in cooling drawer

Quick reference guide

EN

“ This story begins with a cool glimpse of light which easily burns into a creative mind. A story of timeless moments of a serious passion prepared to become a delicious art creation. ”

Thanks for choosing

KitchenAid
FOR THE WAY IT'S MADE.



THANK YOU FOR BUYING A KITCHENAID PRODUCT

In order to receive a more complete assistance, please register your product on www.kitchenaid.eu/register



Before using the appliance carefully read the Safety Instruction.

First time use

Wait at least two hours after the installation before connecting the appliance to the power supply. As soon as you connect the appliance to the power supply, it will start operating automatically. After turning the appliance on, you must wait for 4 to 6 hours for the correct storage temperature to be reached for refrigerators filled to an average capacity.

! Before connecting the appliance, clean the compartments and accessories well with lukewarm water and bicarbonate.

1. Insert the plug into the socket and ensure that the inside light turns on.
2. Turn the TEMPERATURE ADJUSTMENT knob to an average value. After a few hours you will be able to put food in the refrigerator.

Setting the temperature

The temperature inside the refrigerator compartment automatically adjusts itself according to the position of the thermostat knob.

1 = warmest MAX = coldest

We recommend, however, a medium position.

The "cooling section" of the refrigerator is located inside the back wall of the compartment, providing increased space and improved aesthetics. The back wall may be covered in frost or water droplets depending on whether the compressor is operating or paused. This is not a cause for concern; the refrigerator is functioning normally.

If the TEMPERATURE ADJUSTMENT knob has been set to a high value, with large quantities of food inside and a high ambient temperature outside the refrigerator, the appliance will overwork, resulting in high frost formation and high energy consumption; this can be counteracted by turning the knob towards lower temperature values (defrosting will occur automatically).

Using the refrigerator to its full potential

- Use the TEMPERATURE ADJUSTMENT knob to adjust the temperature (see *Drawer parts and Features*).
- Place only cold or lukewarm foods in the compartment, not hot foods (see *Safety Instructions*).
- Remember that cooked foods do not last longer than raw foods.
- Do not store liquids in open containers. They will increase humidity in the refrigerator and cause condensation to form.

Food hygiene

1. Once you have bought your food, remove all external paper/cardboard packaging and any other wrappers which could introduce bacteria or dirt inside your refrigerator.
2. Avoid food items (especially those which are perishable or which have a strong smell) coming into contact with one another; this will reduce the risk of germs or bacteria contamination, as well as the diffusion of strong odors inside the refrigerator.
3. Store all food in such a way as to ensure air can circulate freely between different items.
4. Keep the inside of your refrigerator clean, taking care not to use oxidiser or abrasive products.
5. Remove all food past its expiry date from the refrigerator.
6. For the correct preservation of food, all easily perishable items (soft cheeses, raw fish, meat, etc.) should be stored in the coldest zone of the refrigerator compartment, i.e. in the bottom drawer left side where the temperature indicator is situated.

Drawer Parts and Features

Overall view

The instructions contained in this manual are applicable to different refrigerator models. The diagrams may not directly represent the appliance purchased. For more complex features, please refer to the following

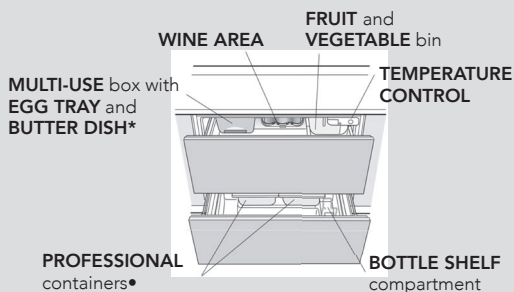

Accessories



MULTI-USE box: Fixed at the top of the compartment, this has been designed to keep various foods for longer periods of time (e.g. eggs, butter or food in small containers); it prevents food odors from permeating into the refrigerator.



WINE AREA: This special accessory is fixed at the top of the compartment and has been designed to hold up to three bottles of wine without taking up extra space. Bottles may be placed in the WINE AREA when it is open; when the compartment is closed it takes up just three centimeters of space inside the refrigerator.



VEGETABLE BINS: Two practical vegetable bins are located in the top compartment. These are easy to remove and may be taken out to be placed on the worktop or for washing.



PROFESSIONAL containers: Two professional containers (with covers) are located in the lower compartment. They have been designed to store meat, cheese or fish.



BOTTLE SHELF compartment: The special stainless steel grilles in the lower compartment can be used to keep two bottles in a stable position.

• Varies by number and/or position.

* Available only on certain models.

TEMPERATURE*: Indicator light: To identify the coldest area in the refrigerator.

1. Check that "OK" appears clearly on the indicator light (see diagram).



2. If the word "OK" does not appear it means that the temperature is too high: Adjust the REFRIGERATOR OPERATION knob to a higher (colder) position and wait approximately 10 hours until the temperature has stabilized.
3. Check the indicator light again: If necessary, readjust it in accordance with the above step. If large quantities of food have been added or if the refrigerator door has been opened frequently, it is normal for the indicator not to show "OK". Wait at least 10 hours before adjusting the REFRIGERATOR OPERATION knob to a higher setting.

Hints and Tips

Defrosting the appliance

The refrigerator has an automatic defrosting function: Water is ducted to the back of the appliance via a special discharge outlet, (see diagram) where the heat produced by the compressor causes it to evaporate. It is therefore not necessary to defrost the refrigerator manually. It is, however, necessary to clean the discharge hole regularly so that the water can flow out easily.

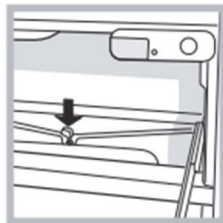

Avoiding mould and unpleasant odors

- The mold is manufactured with hygienic materials which are odor-free. In order to maintain an odor-free refrigerator and to prevent staining, food must always be covered or sealed properly.
- If you want to switch the appliance off for an extended period of time, clean the inside and leave the doors open.

Replacing the light bulb*

To replace the light bulb in the refrigerator compartment, pull out the plug from the electrical socket. Follow the instructions below.

Access the light bulb by removing the cover as indicated in the diagram.

Replace it with a similar light bulb within the power range indicated on the cover (max 10W).

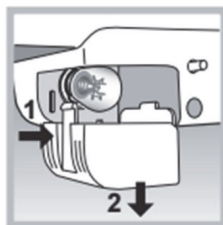

Cleaning

Before cleaning or carrying out maintenance operation, unplug the appliance from the mains or disconnect the electrical power supply.

Never use abrasives. Never clean refrigerator parts with flammable fluids.

Do not use steam cleaners.

The buttons and control panel display must not be cleaned with alcohol or alcohol-derived substances, but with a dry cloth.

Clean the appliance occasionally with a cloth and a solution of warm water and neutral cleaning agents specifically designed for cleaning the inside of a refrigerator.

* Available only on certain models.

Troubleshooting

Before contacting the Customer Service Center:

Restart the appliance to ensure the problem doesn't resolve itself that way. If necessary, repeat this step after one hour.

If the problem persists, we advise you to contact an Authorized Technical Center.

You will need to describe the problem to the technician and provide the precise type and model of your appliance, as well as the Assistance Code found on the data plate inside the refrigerator compartment. This information will enable the technician to immediately identify the type of intervention required.

If a repair is required, we suggest you refer to an Authorised Technical Service Center.

Malfunctions:

The inside light will not turn on.

The refrigerator does not cool properly.

The food inside the refrigerator is beginning to freeze.

The motor runs continuously.

The appliance makes a lot of noise.

There is water at the bottom of the refrigerator.

Possible causes / solutions:

- The plug is not plugged into an electrical socket at all, or insufficiently to make contact. Alternatively, there could have been a power failure in your home.
- The doors do not close properly or the seals are damaged.
- The doors are opened too frequently.
- The TEMPERATURE ADJUSTMENT knob is not in the correct position.
- The refrigerator has been over-filled.
- The TEMPERATURE ADJUSTMENT knob is not in the correct position.
- The door is not closed properly or is repeatedly opened.
- The outside ambient temperature is very high.
- The thickness of the frost exceeds 2-3 mm (see *Hints and Tips*).
- The appliance has not been installed on a level surface (see *Installation*).
- The appliance has been installed between cabinets that vibrate and make noise.
- The internal refrigerant makes a slight noise even when the compressor is off. This is not a defect, this is normal operation.
- The water discharge hole is blocked (see *Hints and Tips*)

Please refer to our website www.kitchenaid.eu for complete instructions for use.

In addition, you will find a lot more useful information about your products, such as inspiring recipes created and tested by our brand ambassadors or the nearest KitchenAid cookery school.

EN

Printed in Italy



400011222811

KitchenAid
FOR THE WAY IT'S MADE.